

 <p>GROSJEAN & MIGNOT ARCHITECTURE SA</p> <p>CH. DE L'EGLISE 3 1188 ST-GEORGE 022 368 17 87 D.MIGNOT@BLUEWIN.CH WWW.GM-A.CH</p>	<p>DÉMOLITION DU BÂTIMENT ECA N°574 ET CONSTRUCTION D'UNE VILLA À DEUX LOGEMENTS</p>							
	<p>PROPRIETE PECOUD CHRISTINE ALICE</p>	<p>905</p>						
	<p>COUVERT</p>	<p>A4-12</p>						
<p>ENQUÊTE</p>	<p>PARCELLE N° 740 AVENUE DE LA ROSIÈRE 10 1188 GIMEL</p>	<table border="1"> <tr> <td>ECHELLE</td> <td>1/100</td> </tr> <tr> <td>DATE</td> <td>30.04.2026</td> </tr> <tr> <td>MODIFICATION</td> <td></td> </tr> </table>	ECHELLE	1/100	DATE	30.04.2026	MODIFICATION	
ECHELLE	1/100							
DATE	30.04.2026							
MODIFICATION								

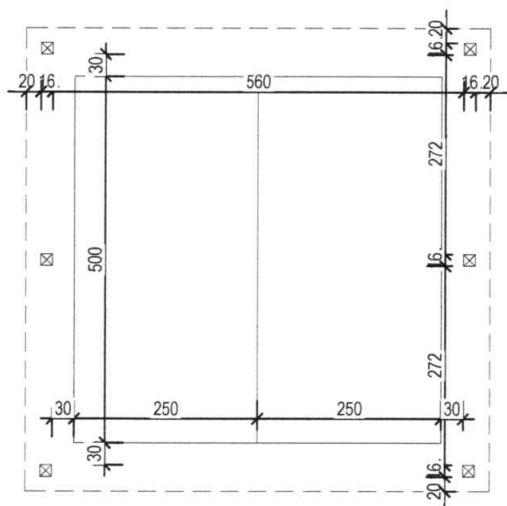

PLAN

ARCHITECTE :

Grosjean

PROPRIETAIRE :

Ch. Pécoud

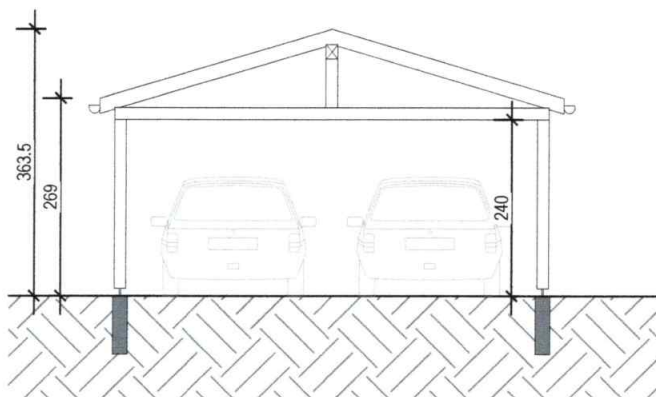
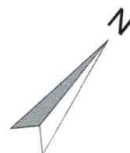

FAÇADE NORD-EST

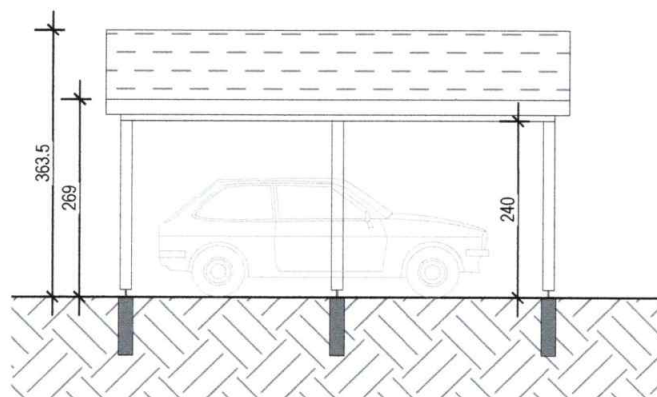

FAÇADE NORD-OUEST

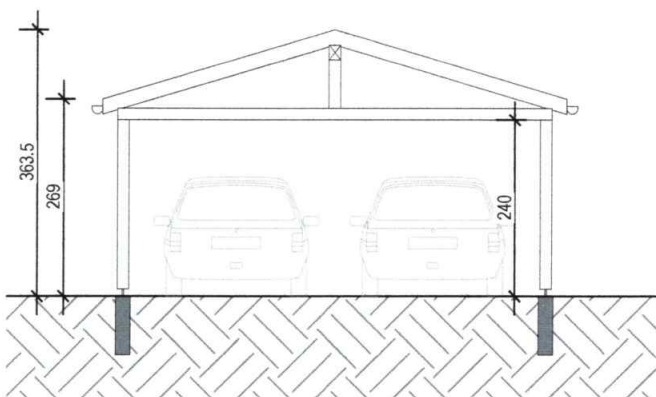

FAÇADE SUD-OUEST

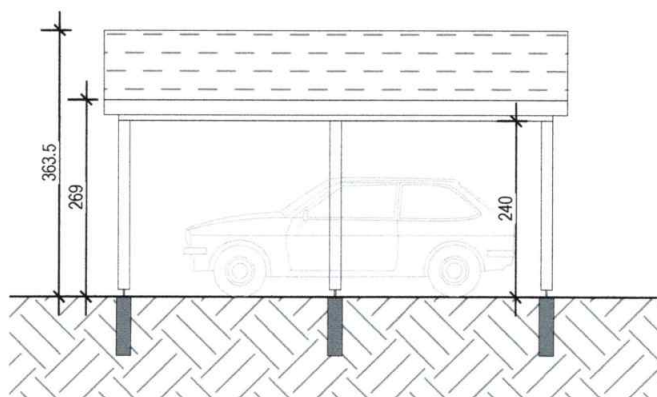

FAÇADE SUD-EST